

329 500 €

Contact agency
CHOMEL IMMOBILIER

06 89 02 27 76 / marjolaine@chomel.immo

For sale apartment

3 rooms

Surface : 61 m²

Year of construction : 2024

Exposition : Est

Hot water : Individuelle gaz

Inner condition : NEW

Features :

lift, double glazing, gated, armored door,
residential, electric blinds, electric shutters

2 bedroom

1 terrace

1 bathroom

1 WC

1 garage

Document non contractuel

19/05/2024 - Prix T.T.C

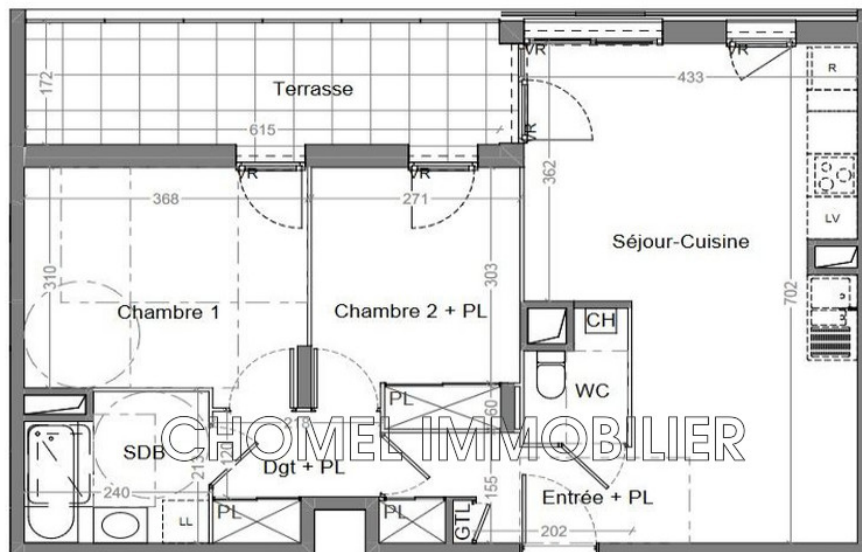

Apartment 174 Villeurbanne

Access to the Lyon ring road just 2 km away via Porte de Cusset. We join the A42 (towards Geneva) and the A43 (Towards Grenoble/Chambéry) in 5 km - Saint-Exupéry Airport 20km away (with access by Rhônexpress tramway in 21 minutes to departure from La Soie station 3 km from the residence): 4th French airport for traffic passenger with 8.7 million passengers in 2015; 115 destinations including 65% international The residence offers a very convenient location: La Part-Dieu is a few minutes away, Le city center of Lyon and a few Tram/Metro stations, the ring road allowing you to get out from Lyon, just 2 km. Nearby amenities: The proximity of all shops and services, which make it an ideal place to live easy and pleasant daily life. The area is very well equipped: Many shops - On the Lyon 3rd side, numerous shops 300m from the residence on the Cours Richard Vitton and to Place Ronde and 500m on Cours Dr Long: bakery, press, doctors, pharmacy, restaurant, supermarket, hairdresser, bank, etc. - On the Villeurbanne side, numerous shops 400m from the residence on Avenue Général Leclerc and to Place Jule Grandclément: bakery, press, doctors, pharmacy, restaurant, supermarket, hairdresser, bank, etc. - For shopping enthusiasts, the Part Dieu shopping center is just 2km from the residence or 2 Tram stations. It is one of the largest shopping centers in Europe, truly emblematic place, which brings together

205 businesses (shops, restaurants and cinema) - Several markets near the avenue du Général Leclerc (Tuesday, market on avenue Saint-Exupéry market on Place Henri (Lyon 3rd) 900m

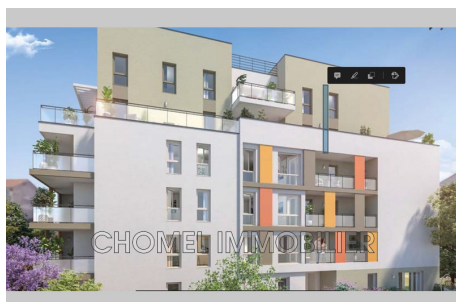

Villeurbanne : une commune dynamique